

Filter cartridges



Filter cartridges

Accessories

FESTO

Filter cartridges, D series,
metal design

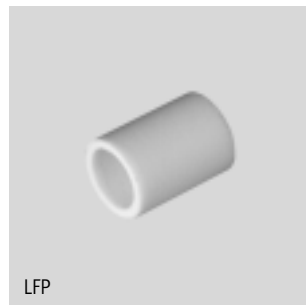

Ordering data				
Size	Filter cartridge	Grade of filtration [µm]	Part No.	Type
Micro	Filter cartridge	5	526818	LFP-D-MICRO-5M
Mini	Micro-filter cartridge	0.01	162674	MS4/D-MINI-LFM-A ¹⁾
	Fine-filter cartridge	1	162677	MS4/D-MINI-LFM-B ¹⁾
	Filter cartridge (colour: blue)	5	159640	LFP-D-MINI-5M
	Filter cartridge (colour: white)	40	363665	LFP-D-MINI-40M ²⁾
	Activated carbon filter cartridge	–	532912	MS4/D-MINI-LFX
Midi	Micro-filter cartridge	0.01	162675	LFMAP-D-MIDI ¹⁾
	Fine-filter cartridge	1	162678	LFMBP-D-MIDI ¹⁾
	Filter cartridge (colour: blue)	5	159594	LFP-D-MIDI-5M ¹⁾
	Filter cartridge (colour: white)	40	363667	LFP-D-MIDI-40M ²⁾
	Activated carbon filter cartridge	–	532788	LFACP-MIDI
Maxi	Micro-filter cartridge	0.01	162676	LFMAP-D-MAXI ¹⁾
	Fine-filter cartridge	1	162679	LFMBP-D-MAXI ¹⁾
	Filter cartridge (colour: blue)	5	159641	LFP-D-MAXI-5M
	Filter cartridge (colour: white)	40	363664	LFP-D-MAXI-40M ²⁾
	Activated carbon filter cartridge	–	532789	LFACP-MAXI

1) Free of copper and PTFE

2) RoHS-compliant

Filter cartridges

Accessories

Filter cartridges, D series,
polymer design



Ordering data						
Size	Filter cartridge	Grade of filtration [µm]	Materials information for filter	CRC ¹⁾	Part No.	Type
Mini	Filter cartridge	5	PE	2	547957	LFP-DB-MINI-5M
	Filter cartridge	40	PE	2	534502	MS4-LFP-E

1) Corrosion resistance class 2 according to Festo standard 940 070
Components subject to moderate corrosion stress. Externally visible parts with primarily decorative surface requirements which are in direct contact with a normal industrial environment or media such as coolants or lubricating agents.

Filter cartridges

Accessories

FESTO

Filter cartridges, MS4/MS6 series



Ordering data						
Size	Filter cartridge	Grade of filtration [µm]	Materials information for filter	CRC ¹⁾	Part No.	Type
MS4	Micro-filter cartridge	0.01	–	–	162674	MS4/D-MINI-LFM-A ²⁾
	Fine-filter cartridge	1	–	–	162677	MS4/D-MINI-LFM-B ²⁾
	Filter cartridge (colour: blue)	5	PE	2	534501	MS4-LFP-C
	Filter cartridge (colour: white)	40	PE	2	534502	MS4-LFP-E
	Activated carbon filter cartridge	–	Active carbon	–	532912	MS4/D-MINI-LFX
MS6	Micro-filter cartridge	0.01	–	–	532909	MS6-LFM-A
	Fine-filter cartridge	1	–	–	532910	MS6-LFM-B
	Filter cartridge (colour: blue)	5	PE	2	534499	MS6-LFP-C
	Filter cartridge (colour: white)	40	PE	2	534500	MS6-LFP-E
	Activated carbon filter cartridge	–	Active carbon	–	532911	MS6-LFX
High flow rate HF						
MS6	Micro-filter cartridge	0.01	Borosilicate fibre	2	552093	MS6-LFM-A-HF ²⁾
	Fine-filter cartridge	1	Borosilicate fibre	2	552092	MS6-LFM-B-HF ²⁾
	Activated carbon filter cartridge	–	Active carbon	2	552094	MS6-LFX-HF ²⁾
Range of application HP, suitable for sealing air and cleaning air						
MS6	Micro-filter cartridge	0.01	Borosilicate fibre	2	547922	MS6-LFM-A ²⁾³⁾
	Fine-filter cartridge	1	Borosilicate fibre	2	547923	MS6-LFM-B ²⁾³⁾
	Activated carbon filter cartridge	–	Active carbon	2	547925	MS6-LFX-AK ¹⁾³⁾

- 1) Corrosion resistance class 2 according to Festo standard 940 070
Components subject to moderate corrosion stress. Externally visible parts with primarily decorative surface requirements which are in direct contact with a normal industrial environment or media such as coolants or lubricating agents.
- 2) Free of copper and PTFE
- 3) RoHS-compliant

Filter cartridges

Accessories

Filter cartridges, MS9 series



Ordering data						
Size	Filter cartridge	Grade of filtration [µm]	Materials information for filter	CRC ¹⁾	Part No.	Type
MS9	Micro-filter cartridge	0.01	Borosilicate fibre	2	553036	MS9-LFM-A ²⁾
	Fine-filter cartridge	1	Borosilicate fibre	2	553037	MS9-LFM-B ²⁾
	Filter cartridge	5	PE	2	570309	MS9-LFP-C ³⁾
	Filter cartridge	40	PE	2	570310	MS9-LFP-E ³⁾
	Activated carbon filter cartridge	–	Active carbon	2	552946	MS9-LFX ²⁾
High flow rate HF						
MS9	Micro-filter cartridge	0.01	Borosilicate fibre	2	552944	MS9-LFM-A-HF ²⁾
	Fine-filter cartridge	1	Borosilicate fibre	2	552945	MS9-LFM-B-HF ²⁾

- 1) Corrosion resistance class 2 according to Festo standard 940 070
Components subject to moderate corrosion stress. Externally visible parts with primarily decorative surface requirements which are in direct contact with a normal industrial environment or media such as coolants or lubricating agents.
- 2) Free of copper and PTFE
- 3) RoHS-compliant

Filter cartridges

Accessories

FESTO

Filter cartridges, MS12 series

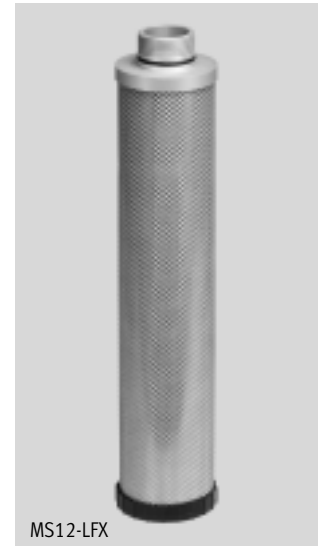

Ordering data							
Size	Filter cartridge	Grade of filtration [µm]	Materials information for filter	CRC ¹⁾	Weight [g]	Part No.	Type
MS12	Micro-filter cartridge	0.01	Borosilicate fibre	2	425	537146	MS12-LFM-A²⁾³⁾
	Fine-filter cartridge	1	Borosilicate fibre	2	395	537145	MS12-LFM-B²⁾³⁾
	Filter cartridge	5	Sintered bronze	2	295	537143	MS12-LFP-C
	Filter cartridge	40	Sintered bronze	2	295	537144	MS12-LFP-E
	Activated carbon filter cartridge	-	Active carbon	2	445	537147	MS12-LFX²⁾³⁾

1) Corrosion resistance class 2 according to Festo standard 940 070

Components subject to moderate corrosion stress. Externally visible parts with primarily decorative surface requirements which are in direct contact with a normal industrial environment or media such as coolants or lubricating agents.

2) Free of copper and PTFE

3) RoHS-compliant